

WOOLDRIDGE SQUARE\_stakeholder meeting #4  
2016 /07/08

# AGENDA

INTRODUCTION

SURVEY ANALYSIS

VISION

DESIGN REVIEW

BREAKOUT

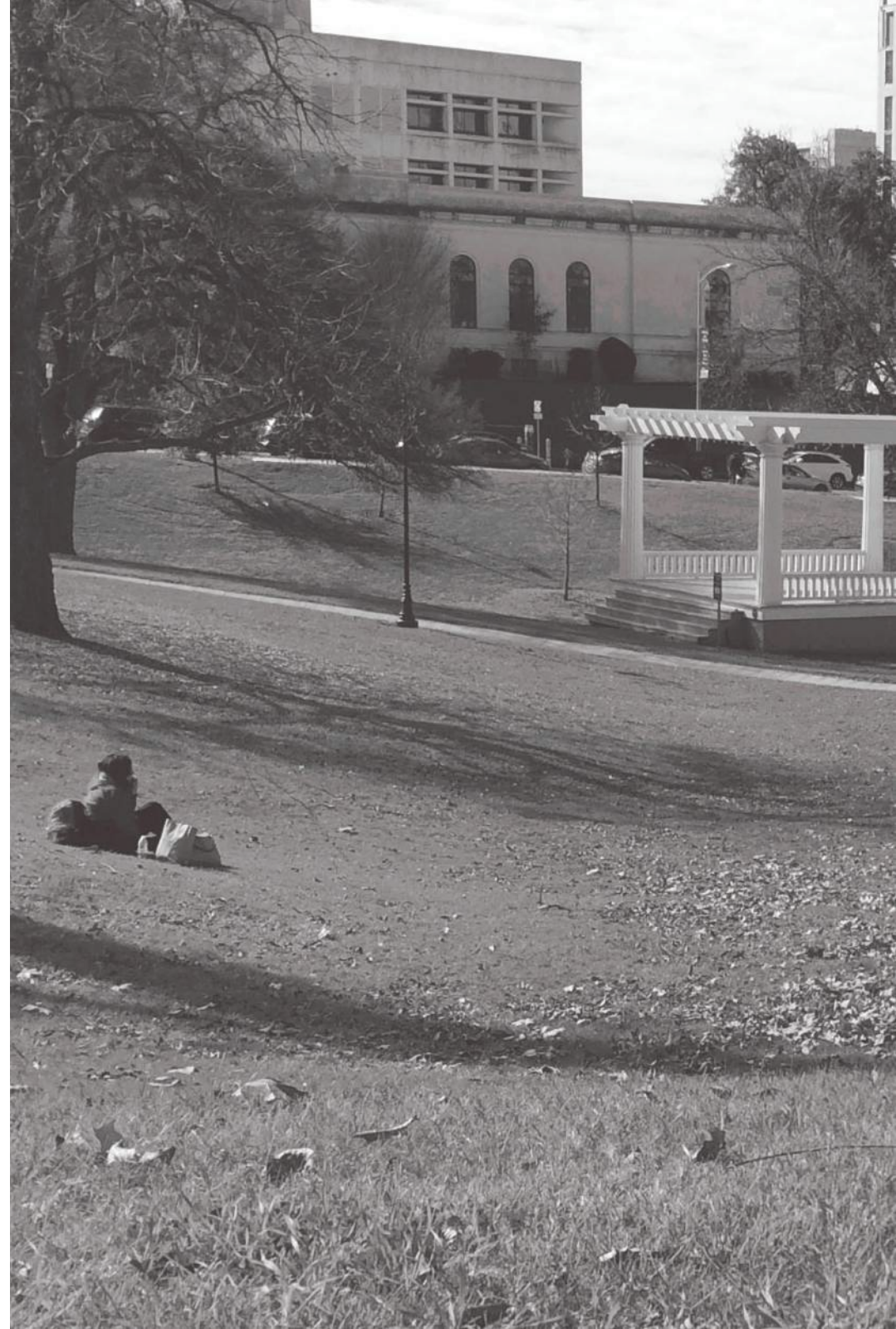

# INTRODUCTION

# PROJECT SCHEDULE

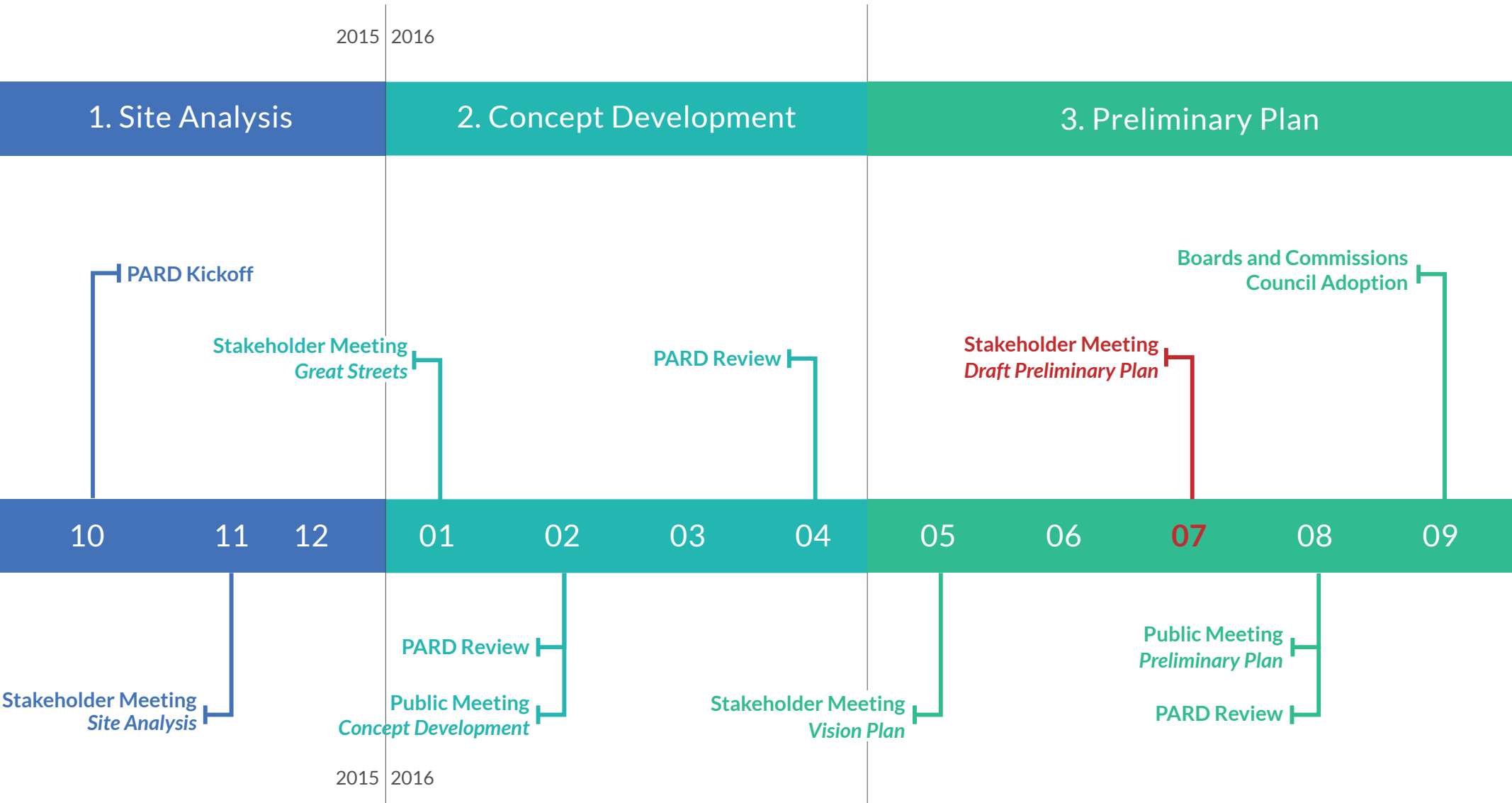

# SURVEY ANALYSIS



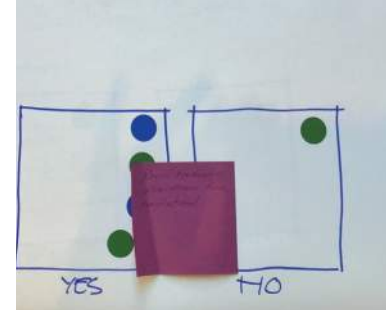

- 1. Regular programmed events
- 2. Art market
- 3. Night events
- 4. Day events
- 5. Movies in the park
- 6. Symphony night
- 7. Yoga
- 8. Mobile library
- 9. Children's adventure playground
- 10. Giant chess
- 11. Enhanced concession and food options
- 12. Designated events coordinator
- 13. Park security



Wooldridge Square is an historically significant place. These findings tell us how to preserve and celebrate that history as we improve other aspects of the Square.

### AREAS OF CONSENSUS

- Wooldridge Square has been on the National Register of Historic Places since 1979.
- The existing walk (A) and Bandstand (B) must retain their historical alignment and character.

### AREAS FOR IMPROVEMENT

- There is an opportunity to reveal the historical location of Little Shoal Creek (C).

### SURVEY RESPONSES

#### HISTORIC WALK

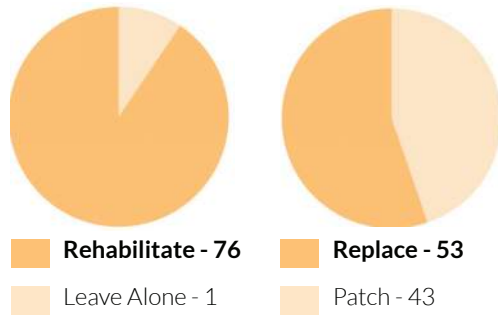

#### LITTLE SHOAL CREEK

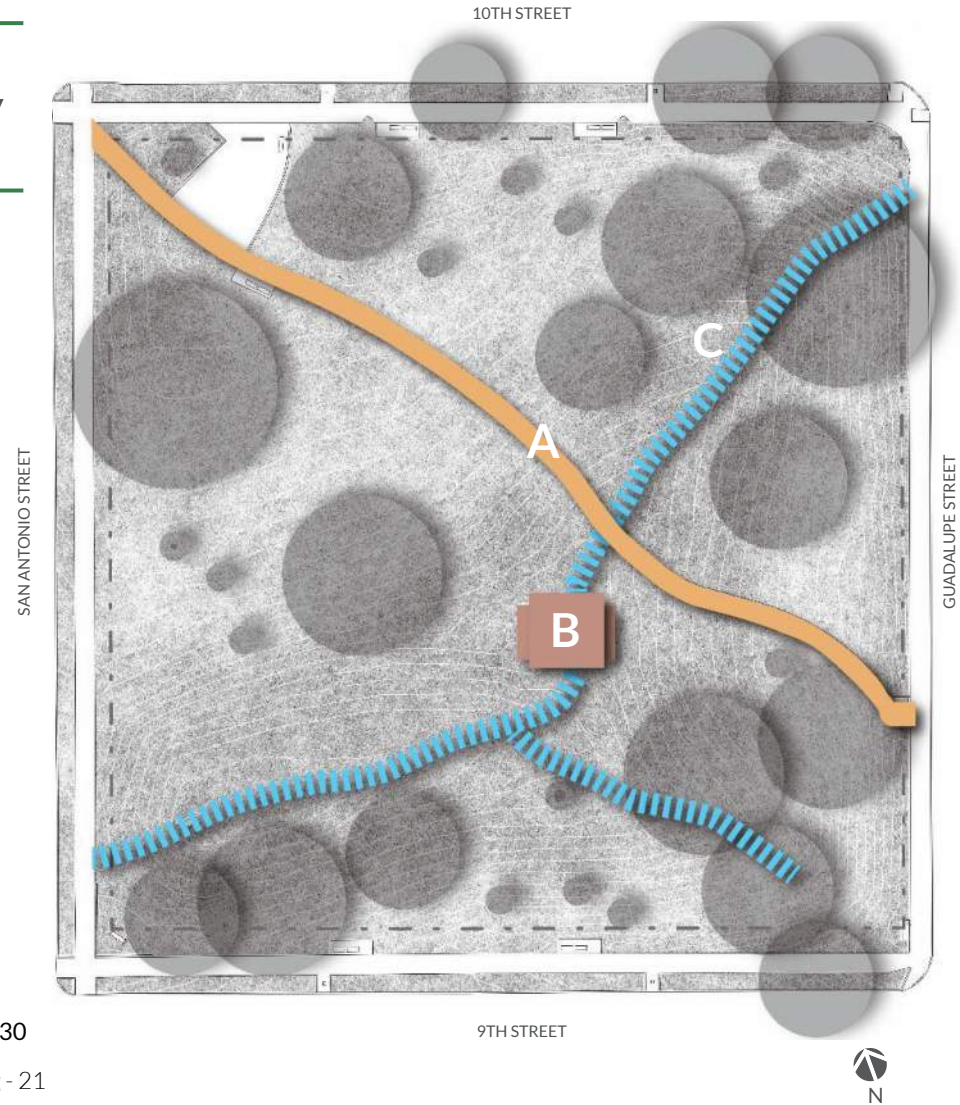
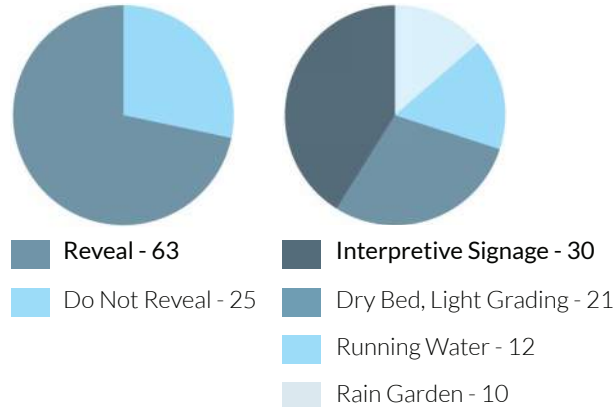





# ACCESSIBILITY

Wooldridge Square does not meet current accessibility standards as required by law. These findings confirm that better access must be considered and reveal ways to make changes sensitive to the existing Square.

## AREAS OF CONSENSUS

- Surveyed constituents do not want accessibility to dominate historic features.

## AREAS FOR IMPROVEMENT

- Surveyed constituents strongly preferred the proposal of an additional accessible path - shown right - over proposals to realign the existing walk.
- The Square currently lacks ADA compliant access to and onto the Bandstand - this was voted by constituents as *one of the top five desired infrastructure upgrades*.
- Constituents also voiced a desire for ADA compliant parking.

Some constituents suggested an ADA compliant platform off Guadalupe for viewing concerts and events.

As a location of primary function in the Square, the Bandstand must be accessible.

The preferred path type should follow the existing topography and minimize impact to existing trees.

Accessible parking proposed on San Antonio Street, where access to the proposed ADA path to the Bandstand is most convenient.

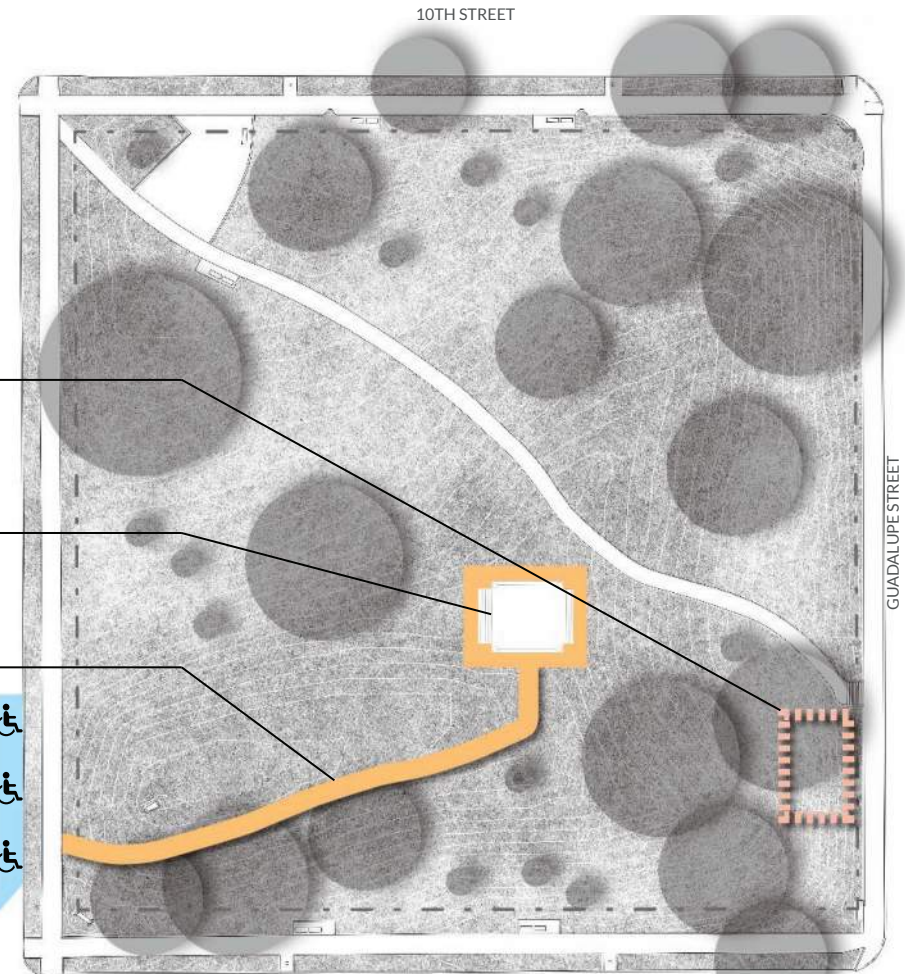

9TH STREET







# GREAT STREETS

The Great Streets Program serves to improve the quality of downtown streetscape. These findings tell us which unique aspects of this block to acknowledge as we consider Great Streets.

## AREAS OF CONSENSUS

- Landmark viewsheds in and out of the Square must be preserved. (A, B, & C)
- The Great Streets improvements shall “push” out into the ROW. Parking, curbs and roadways should be modified.

## AREAS FOR IMPROVEMENT

- Surveyed constituents preferred the hybrid version of Great Streets (plan shown right) over a “one size fits all” implementation.
- 9th and 10th streets should celebrate the proximity and visual connection of the County courthouse and the History center.
- Current limitations include narrow sidewalks and not enough street trees.



Many people want to retain the bike lane on Guadalupe (D)



Surveyed parties agreed to the merits of a wider, 18' sidewalk

Landmark viewsheds include The Austin History Center (A), the Travis County Courthouse (B), and the State Capitol (C).

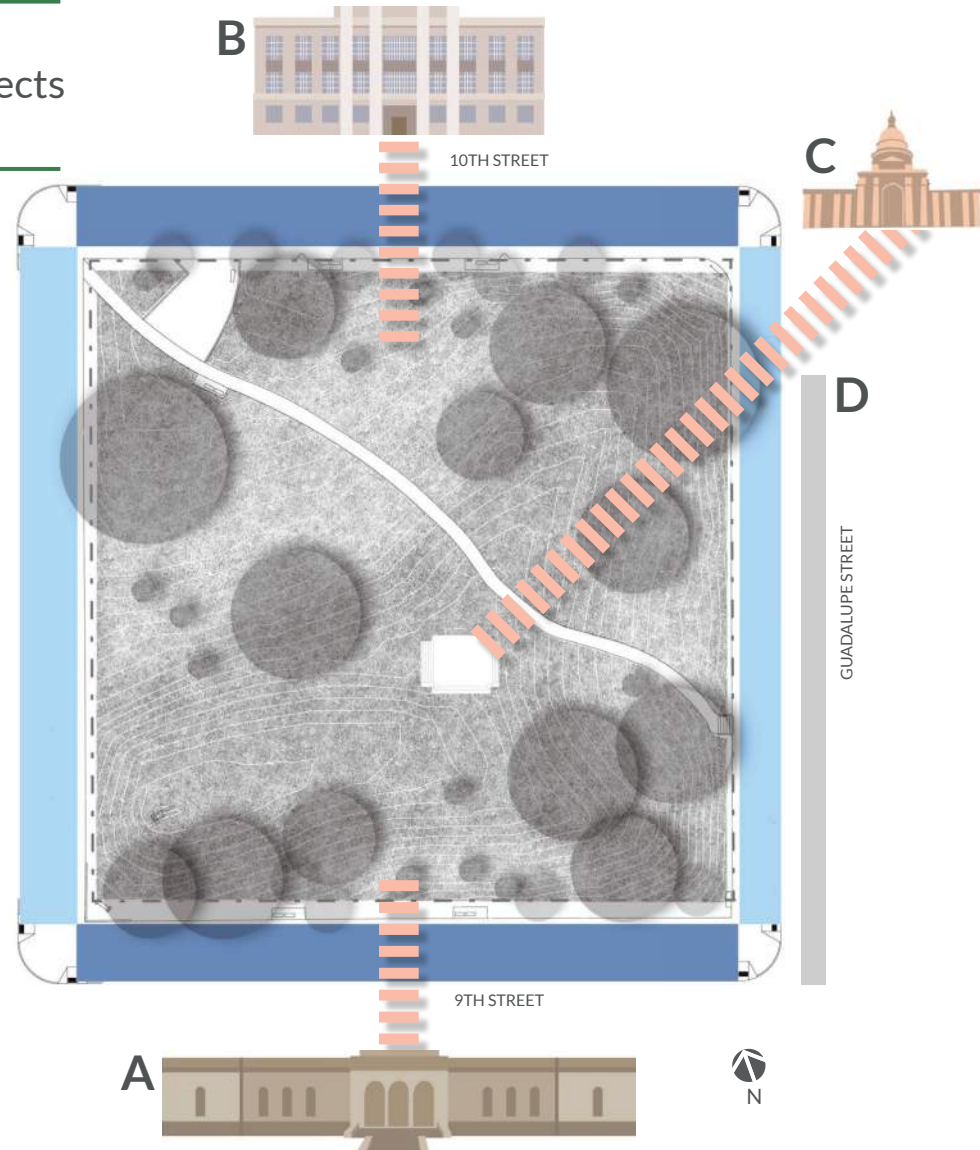



# VISION

Constituent feedback tells us how people want to use the Square and how they think it should function. These findings tell us what functions to support when changing areas of the Square.

## AREAS OF CONSENSUS

- Wooldridge should have a role among downtown Austin's open spaces.



## AREAS FOR IMPROVEMENT

- Wooldridge Square must be able to support constituents' desired uses of the space - if it is not used, it will not be successful.
- Several stakeholders commented in support of closing 10th street to vehicular traffic, resulting in a total of ten people speaking in favor of a potential closure.
- Constituents spoke in favor of amenities near the Square, including restrooms, drinking fountains, and flexible space.

## CIVIC PROGRAMMING

1. Movies in the Park
2. Night Events
3. Day Events
4. Symphony Night
5. Art Market

## INFRASTRUCTURE UPGRADES

1. Better Shade
2. Lighting Upgrades
3. Drinking Fountain
4. Better Seating
5. ADA Bandstand access

## ENVIRONMENTAL PERFORMANCE

1. Enhanced Tree Planting
2. Transplanted Heritage Trees
3. Reclaimed Water for Planting
4. Native Meadows
5. Reduced Maintenance

*In a survey listing elements of Civic Programming, Infrastructure Upgrades, and Environmental Performance, constituents chose these as their Top 5 in each category.*



### ACHIEVE ACCESS

*achieve universal access to give everyone in the community the opportunity to experience the historic Bandstand*



### ELEVATE THE PEDESTRIAN

*activate the perimeter to create a safe and inviting experience for the pedestrian*



### REINFORCE CONNECTION

*invest in critical infrastructure to reinforce and support the Square's presence in the Austin community*



### INVEST IN OUR PAST

*use the Square's unique and historic defining features to guide low impact design and tell the story of the Square*

VISION





Wooldridge Square will be a place of civic tradition and an urban open space for all in the Austin community