

INTRODUCTION

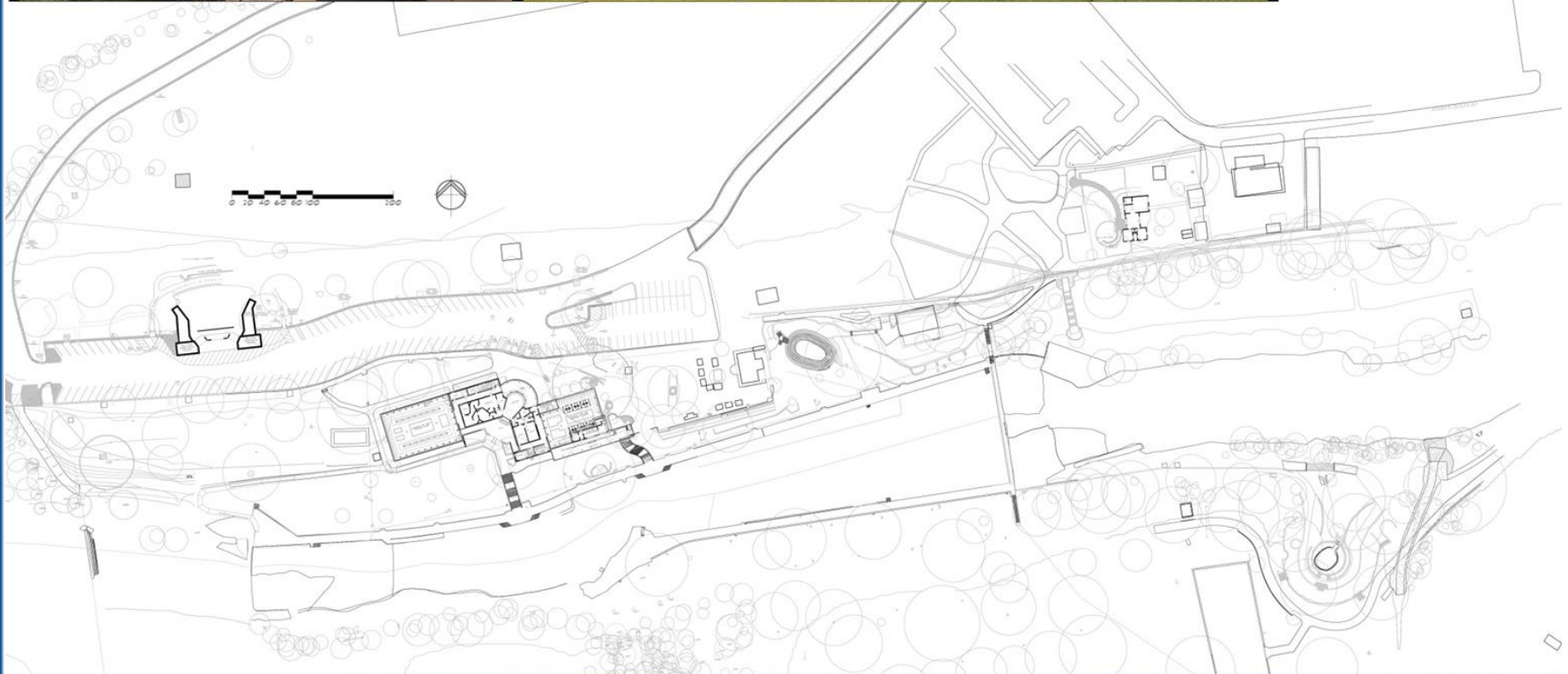

ZILKER PARK IMPROVEMENTS AT THE BATHHOUSE ZONE

PROJECT SUMMARY



2008
Barton Springs Pool
Master Plan

2012
Bond funding
provided for Facility
Renovation and
Improvements

June-Sept 2015
Condition
Assessment for
Zilker facilities in
Bathhouse Zone

October 2015
Open House

TODAY
Public Input
Focus Group

Nov - Dec 2015
Public Input, Concept
review and
Recommendations

WINTER-SPRING
2016
Begin Design of
Initial funded
projects

2017
Construction

ZILKER PARK IMPROVEMENTS AT THE BATHHOUSE ZONE



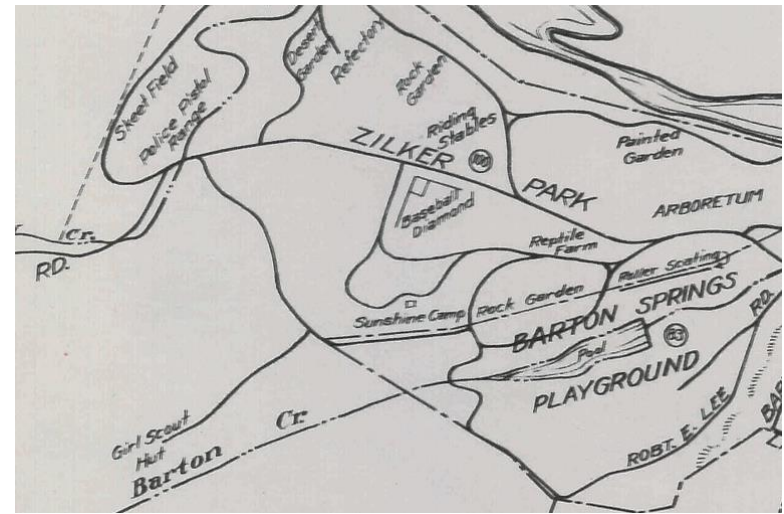
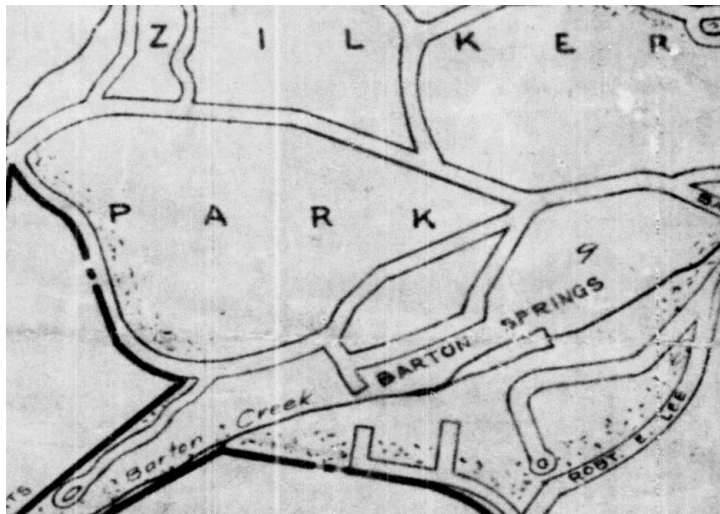
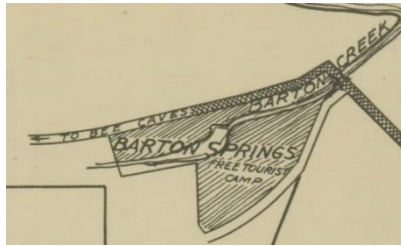

ZONE PLAN



ZILKER PARK IMPROVEMENTS AT THE BATHHOUSE ZONE



CONSTRAINTS

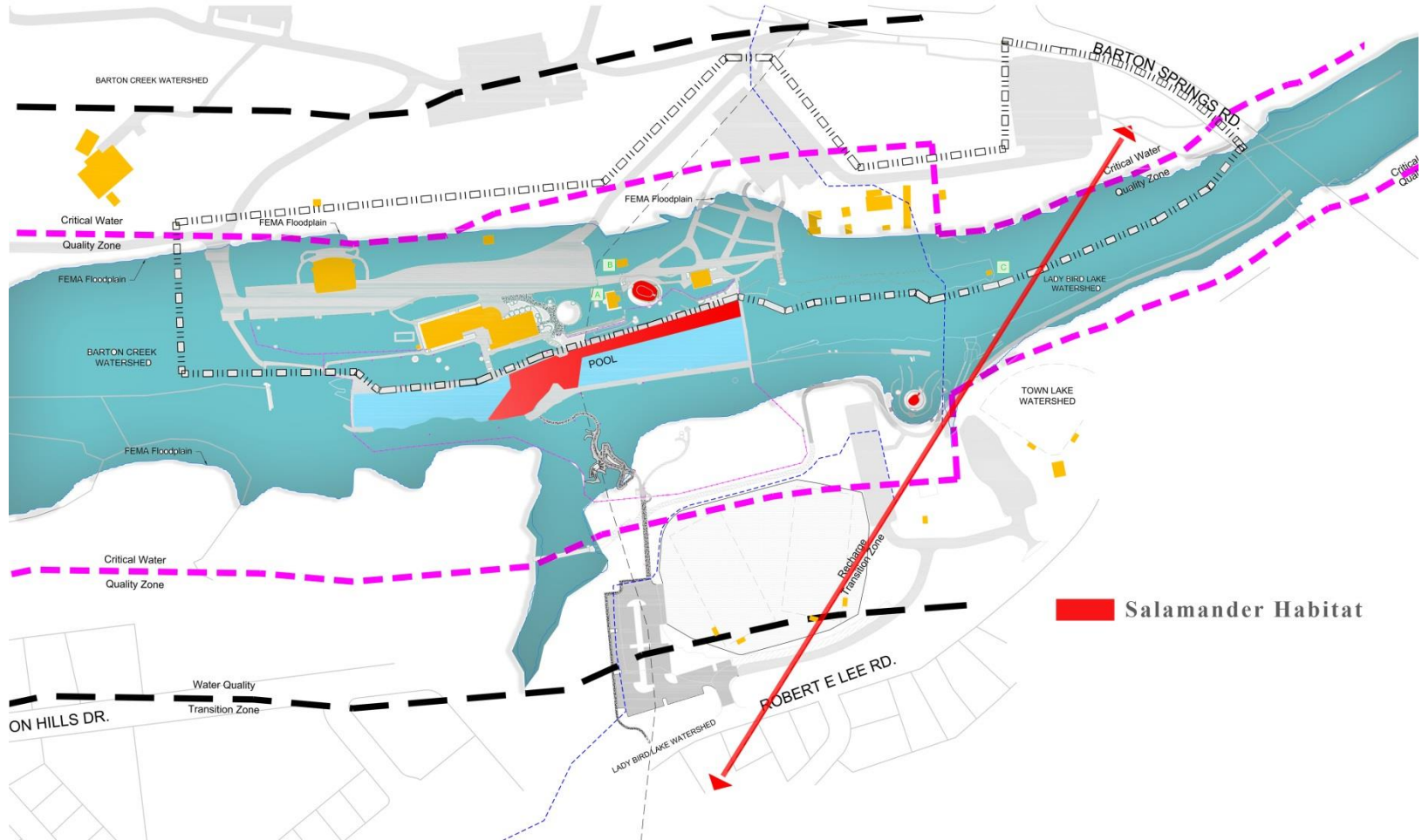

BATHHOUSE ZONE INFRASTRUCTURE AND AMENITIES



ENVIRONMENTAL PRESERVATION

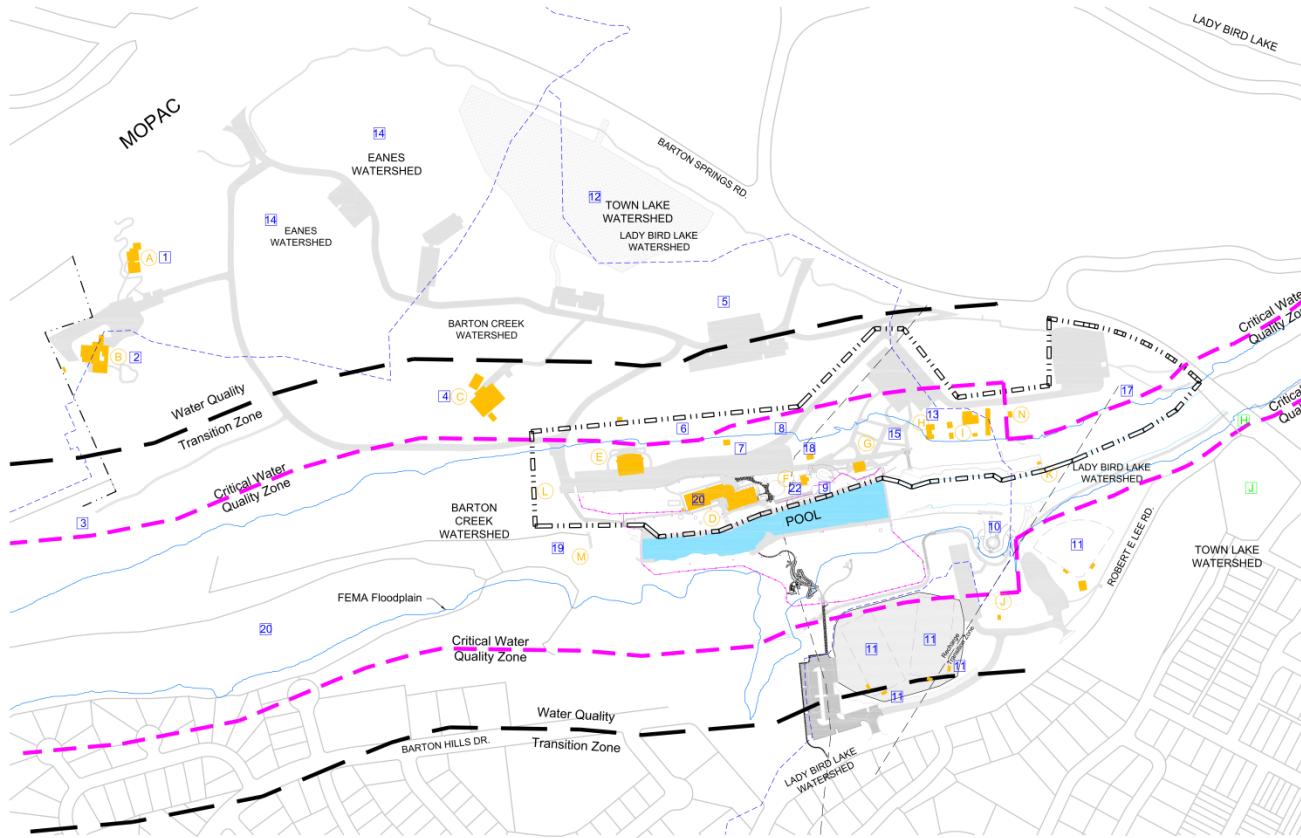

KEY LEGEND

- Zilker Park Improvements at the Bath House Zone Boundary
- EXISTING BUILDINGS/FACILITIES
 - A McBeth Recreation Center - Knights of Columbus Building
 - B McBeth Recreation Center - Main Building
 - C Sunshine Camp
 - D Barton Springs Bathhouse and Splash Exhibit
 - E Zilker Hillside Theater
 - F Barton Springs Concession / Zilker Cafe
 - G Playscape Pavilion
 - H Zilker Caretaker Cottage
 - I Zilker Maintenance Barn
 - J Southside Restrooms
 - K Canoe Rental
 - L Barton Creek Trail Head
 - M Gravel Trap Dam
 - N Octagonal Restrooms
- EXISTING ROADWAYS, PARKING AND CONCRETE WALKWAYS
- EXISTING HISTORICAL AND CULTURAL RESOURCES AT ZILKER PARK

Zilker Park is a district under the National Register of Historic Places. The Zilker Park Historic District consist of a cohesive group of resources developed between 1917 and 1947 as an urban park and recreation facility. The park's resources consist of prolific works from the 1930's Civil Works Administration and Civilian Conservation Corps along with later improvements. The 350 acre park as a whole retains the historic landscape characteristics integral to its intended design and use, therefore retaining a high degree of integrity as a designed historic landscape in terms of location, design, setting, materials, workmanship, feeling, and association. There are numerous State of Texas Antiquities Landmarks as well as City of Austin designated Historic Landmarks.

- 1 Knights of Columbus Building
- 2 McBeth Recreation Center
- 3 Girl Scout Hut
- 4 Sunshine Camp
- 5 Moonlight Tower
- 6 Rock Garden
- 7 Bandstand
- 8 Entry Lamp Post
- 9 Eliza Springs
- 10 Sunken Gardens
- 11 Wright Field / Historic Dug Outs
- 12 Polo Grounds
- 13 Zilker Caretaker Cottage
- 14 Disc Golf Course
- 15 Zilker Playscape
- 16 Barton Springs Pool
- 17 Pecan Grove Picnic Area
- 18 Zilker Zephyr Railroad
- 19 Bridge Abutment
- 20 Upper Barton Springs
- 21 Barton Springs Pool
- 22 Zilker Cafe

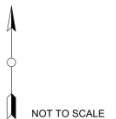

ZILKER PARK IMPROVEMENTS AT THE BATHHOUSE ZONE

PARKING

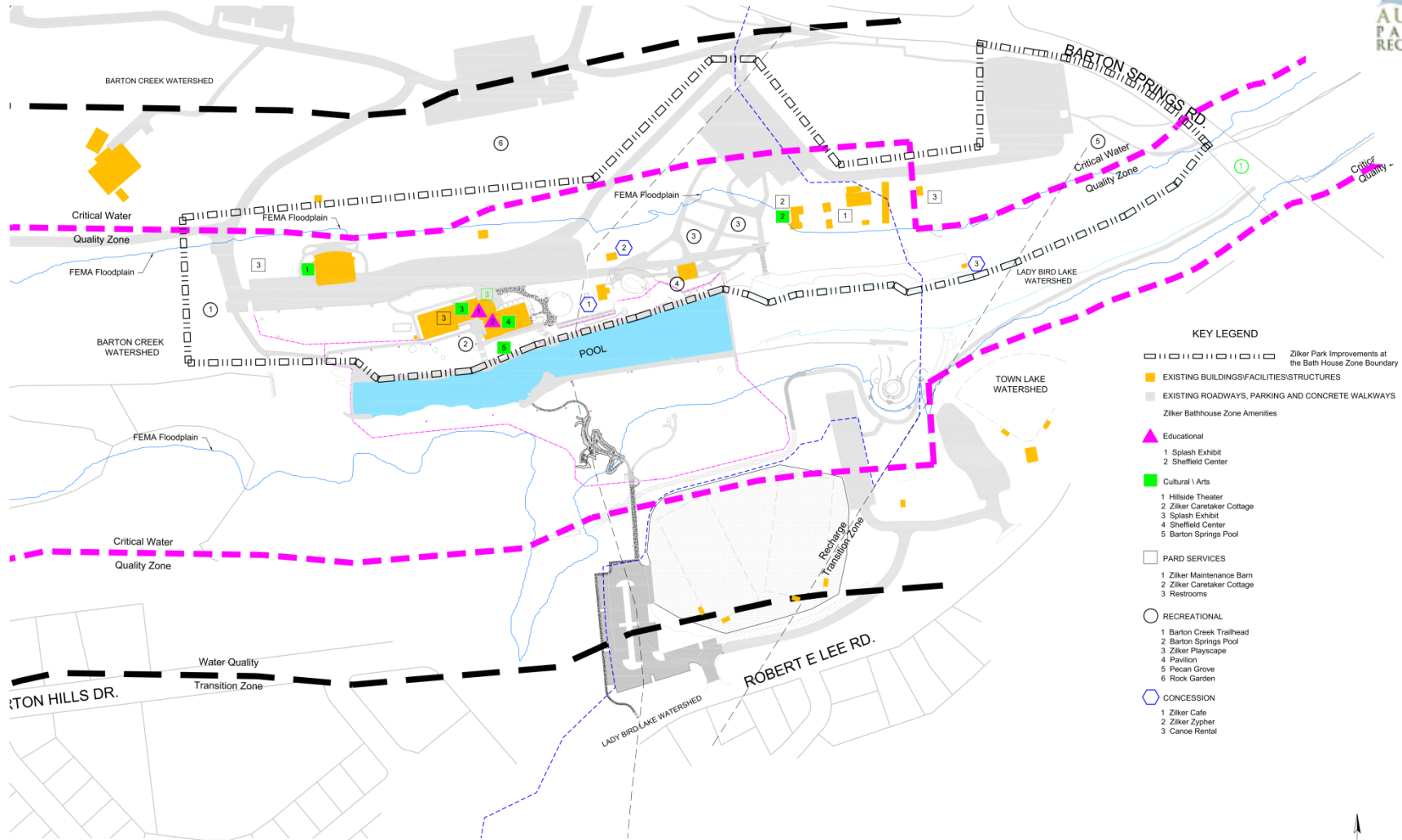

KEY LEGEND

- Zilker Park Improvements at the Bath House Zone Boundary
- EXISTING BUILDINGS/FACILITIES/STRUCTURES
- EXISTING ROADWAYS, PARKING AND CONCRETE WALKWAYS
- Zilker Bathhouse Zone Amenities**
- Educational
 - 1 Splash Exhibit
 - 2 Sheffield Center
- Cultural / Arts
 - 1 Hillside Theater
 - 2 Zilker Caretaker Cottage
 - 3 Splash Exhibit
 - 4 Sheffield Center
 - 5 Barton Springs Pool
- PARK SERVICES
 - 1 Zilker Maintenance Barn
 - 2 Zilker Caretaker Cottage
 - 3 Restrooms
- RECREATIONAL
 - 1 Barton Creek Trailhead
 - 2 Barton Springs Pool
 - 3 Zilker Playscape
 - 4 Pavilion
 - 5 Pecan Grove
 - 6 Rock Garden
- CONCESSION
 - 1 Zilker Cafe
 - 2 Zilker Zephyr
 - 3 Canoe Rental

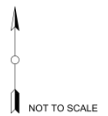

ZILKER PARK IMPROVEMENTS AT THE BATHHOUSE ZONE

AMENITIES AND CONCESSIONS

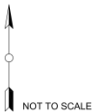
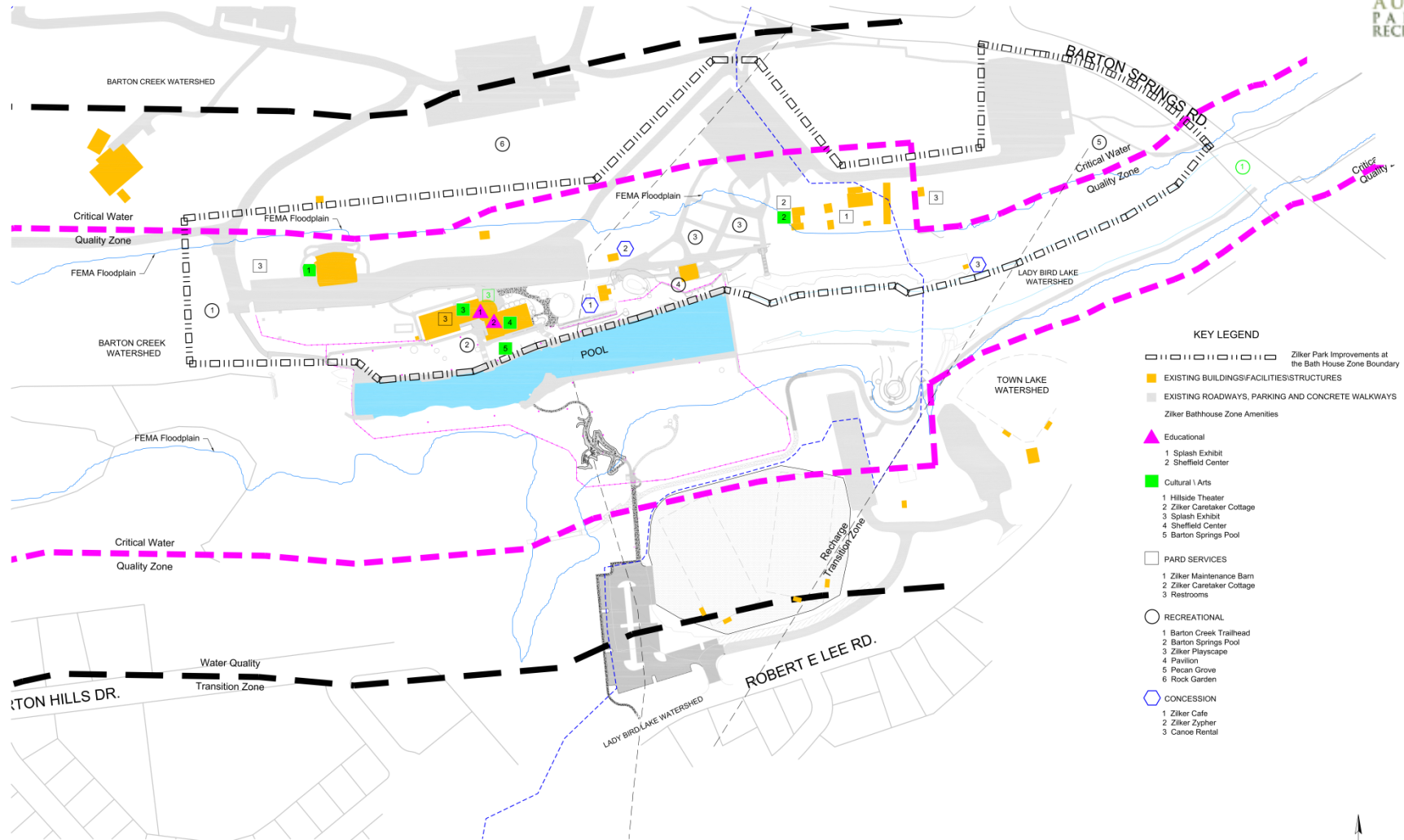

ZILKER PARK IMPROVEMENTS AT THE BATHHOUSE ZONE



PEDESTRIAN AND BIKE CIRCULATION

