



ALLIANCE CHILDREN'S GARDEN

CONCEPTUAL DESIGN MEETING • JANUARY 7, 2016



ENGAGEMENT SCHEDULE

DECEMBER 5, 2015

community engagement meeting #1

JANUARY 7, 2016

conceptual design meeting

FEBRUARY, 2016

community open house

OTHER ENGAGEMENT OPPORTUNITIES

online survey, website, email, phone



PROJECT SCHEDULE

SPRING 2016

completion of design development phase
begin construction document phase

SPRING 2017

begin construction of garden

SPRING 2018

anticipated opening Alliance Children's Garden



DOUGHERTY ARTS CENTER

ALLIANCE CHILDREN'S GARDEN
EXISTING SITE

WET POND

LIZ E. CARPENTER
FOUNTAIN

DOUG SAHM HILL

WILLIE WELLS FIELD

W RIVERSIDE DR

WHERE WE ARE





WHY WE'RE HERE

This place is to be a **children's garden** that will represent the unique **culture of Austin** through **contextual forms, imaginative play, playful elements, and strong aesthetics.**

The goal will be the creation of a **multigenerational** play venue that is **comfortable, inviting, imaginative, engaging** and **visually striking.**



WHERE WE'RE HEADED

MEETING #1











2 GARDEN MEMORY

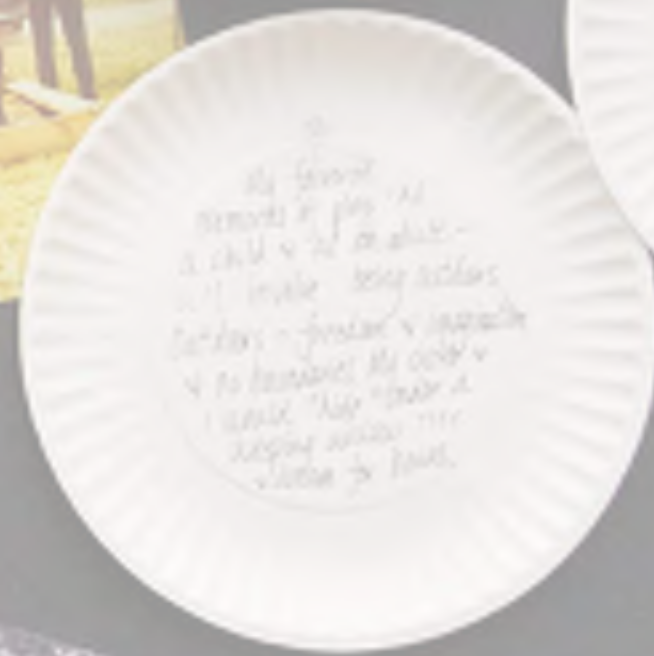

2 GARDEN MEMORY

"I made friends here because many of the things required several kids working together to make them work"



"My sister and I would 'hide' under a weeping willow tree and dream for hours"

2 GARDEN MEMORY



"The smell of pine needles and cold sand makes my heart smile"

1 GARDEN FOCUS



CREATIVE, EXPERIENTIAL PLAY

VOTES
17



VISUALLY STRIKING, IMAGINATIVE DESIGN

VOTES
7



MULTIGENERATIONAL, FAMILY OPPORTUNITIES

VOTES
3



PROGRAMMED ACTIVITIES, PERFORMANCES

VOTES
3



REGIONAL ENVIRONMENTS, SUSTAINABILITY

VOTES
2



MUSIC, SENSORY DEVELOPMENT

VOTES
1



ART, CULTURE, HISTORY

VOTES
1



HORTICULTURE, HABITAT CREATION

VOTES
1

1 GARDEN FOCUS



CREATIVE, EXPERIENTIAL PLAY

VOTES
17

• LIKE THIS FOCUS?
DROP YOUR FROG OR FISH IN THE BUCKET

tell us what you think (area for comments)

I think it would be great to have an area where children can play with water. This could be a small pond or a water feature that is safe for children to play in. It could be a good idea to have a water feature that is not too deep and has a soft landing area. This would be a great addition to the garden and would provide a lot of fun for the children.

Very nice idea for children. Great!

water table
- zip line
- slide built into hill
- logs and stumps for jumping
- Margret (8 years old)

The bottom left picture seems so great! My kids love climbing, swinging, jumping and not necessarily on a playground structure. They would love (the picture)!

My kid loves from the picture

Nature Play

Love the idea of a water feature. It would be a great addition to the garden.

This is a great idea. It would be a great addition to the garden and would provide a lot of fun for the children.

ALLIANCE CHILDREN'S GARDEN

“The bottom left picture seems so great! My kids love climbing, swinging, jumping and not necessarily on a playground structure. They would love (the picture)!”

“Wish List

- zip line
- slide built into hill
- logs and stumps for jumping”

- Margret (8 years old)

1 GARDEN FOCUS



VISUALLY STRIKING, IMAGINATIVE DESIGN

VOTES
7

• LIKE THIS FOCUS?
DROP YOUR FROG OR FISH IN THE BUCKET

tell us what you think (area for comments)

IN THE SMALL MORE THAN
IN THE LARGE

USE SCULPTURE

↳ note about
actual sculptures?
it would be great
photo op:

Top right image could be
something "iconic" for the park.
I could see myself telling other
families to enter through the
"south side of the park by the rock
structure" (as an example).

Let's Be Unique!
Awesome for all ages!
Iconic!

opportunity to highlight
Austin nature. i.e. Barton Springs salamander,
limestone, golden chert, water, etc.

Top left picture looks awesome, love the idea of structures to act as shade & something beautiful or interesting to look at.
Top left picture looks "too urban" - not nice!

I love the buildings in the upper left -
they look like miniature skyscrapers! It gives
the park an urban feel while still appearing
whimsical.
-GEM

TBG  ALLIANCE CHILDREN'S GARDEN

"Top left picture looks awesome, love the idea of structures to act as shade and something beautiful or interesting to look at."

"Top right image could be something 'iconic' for the park.
I could see myself telling other families to 'enter through the
South side of the park by the rock structure' (as an example)."

3 GARDEN EXPERIENCES

PICNICS, EVENTS, FAMILY GATHERING



comfortable open space

• • •
- the freedom to sit and enjoy
time w/ the family is so important
I think the space would be better
if there is no pavement because it
looks nice and accessible etc.

sticker dots ("I like this")

tell us what you think (area for comments)



playful picnic tables

these are lovely!
★

sticker dots ("I like this")



variety of gathering spaces

sticker dots ("I like this")



flexible seating

•
Cute, but please
no bike

sticker dots ("I like this")



events



passive family activity

we can do this in Tenbyke trail now

sticker dots ("I like this")

UNEXPECTED, CHANGING EXPERIENCES



3 GARDEN EXPERIENCES

VOTES
12

SWINGING, SPINNING, SLIDING



swings
I would like low-lying swings, as well as high swings, called Peter Pan swings.
abstract spins and swings
I would like low-lying swings, as well as high swings, called Peter Pan swings.

VOTES
15



slides
great long slide
love wide slides with enough for adults!!

VOTES
10



rotating climbing
I love this!



covered porch swings
I love this!

“Love wide slides... wide enough for adults!!”

“I think swings that have different lengthed mallets attached to the top of each swing, and angled strings above the mallets, so that when the swings moved the mallets would strike different strings, which would essentially play different notes (or just different sounds). When Multiple people were swinging it would play different sounds depending on how many people, how high they were swinging, etc. This would not only be interactive and enjoyable for all ages, but kids could also see how the music or tones are being made. Also, pathways to walk on could also make sounds, the slides could have tones that vary depending on speed/pressure. Basically, the sound of playing could basically make music, which would be perfect for a music town.”

“My kids run to swings in any park!”

3 GARDEN EXPERIENCES

VOTES
14

EXPLORING, DISCOVERING

				
constructed nature spaces 	paths 	found elements 	variety of enclosure 	urban constructed follies 

“Creates natural spots of shade!”

“This entire ‘Exploring’ theme is amazing!”

3 GARDEN EXPERIENCES

VOTES
11

UNEXPECTED, CHANGING EXPERIENCES

					
<p>constructed visually striking</p> <p>1/20 2018</p> <p>5 red dots</p>	<p>dual function elements</p> <p>with an eye to some level of social play</p> <p>2018</p> <p>5 red dots</p>	<p>circuitous activities</p> <p>2018</p> <p>5 red dots</p>	<p>hide and seek spaces</p> <p>2018</p> <p>5 red dots and 2 stars</p>	<p>natural materials visually striking</p> <p>2018</p> <p>2 red dots and 1 star</p>	

“My kiddo LOVES peek-a-boo.”

“My favorite part of going to the park as a really little kid!”

3 GARDEN EXPERIENCES

VOTES
9

COMFORT, SHADE, EATING

						
variety of small eating areas	passive small open spaces	shade structures <i>We don't want to be back shade without shade in another part A this is a good shade but if you live in Seattle!</i>	shade structures	cooling features <i>(the one at the playground is really super hot - that's not good)</i>	shaded walks	area for food trucks
	●	● ● ● ● ●	● ● ● ● ●	● ●	● ●	●

“Shadow pattern could include Austin nature instead of letters: native plants, water symbols, iconic Austin animals, monarch, etc. Maybe with native vine to increase shade.”

“Need shade at both play areas & areas where children aren’t (parents.)”

4 GARDEN CASE STUDIES



4 GARDEN CASE STUDIES



TEARDROP PARK

"If incorporated should mimic limestone walls in Barton Creek Greenbelt"



TONGVA PARK

"Like the mix of synthetic and natural materials like architecture play items"



HELEN DILLER PARK

"Too prescribed"
"Like the sense of boundary"
"Nice climbing web"
"Too much artificial landscape!"



LAFAYETTE PARK

"Love the sandy hills! Look better than synthetic ones"
"Like natural climbing elements"
"Needs shade"

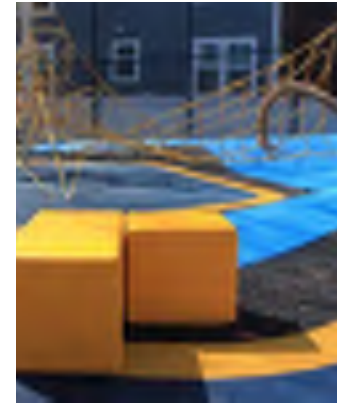

THOMAS J. SWEENEY PLAYGROUND

"Too much synthetic material"



BROOKLYN BRIDGE PARK

"Like the greenery for the feel of enclosure and views, good sensory experience"
"Love the perception of danger and adventure..."
"Love tiered seating"

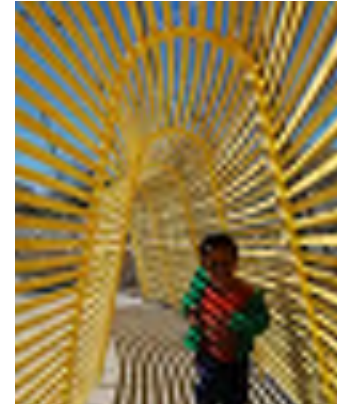

WOODLAND DISCOVERY PLAYGROUND

"Kids love tunnels and areas that are just their size"



MAGGIE DALEY PARK PLAY GARDEN

"Like the berm slides"
"Love the mini buildings"

5 GARDEN CONTEXT

- I do many tasks for Urban Adventure races in the park.
- I practice my handstands here.
- I walk do

Sharpie

5 GARDEN CONTEXT

“We love the big oval paved sidewalk for riding bikes”

“We always bring out of town guests”



“I ride my bike on trails to get to Town Lake”

“Picnics in the park”

“I enjoy the view from Doug Sahm Hill”

ONLINE SURVEY

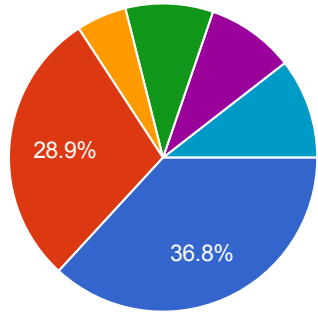

What best characterizes the City of Austin?

36.8% Austin is Creative.

28.9% Austin is Connected to Nature.

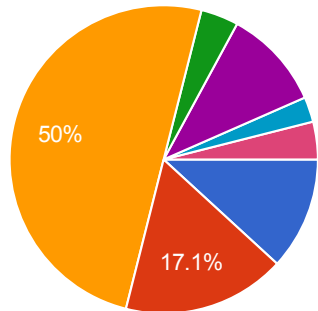

What best characterizes Town Lake Park?

50% Austin's Central Park

17.1% Family and Community Focused

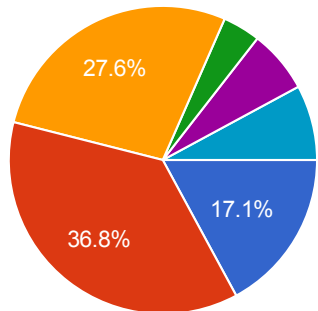

What is the greatest opportunity for the Alliance Children's Garden in Butler Park?

36.8% Spaces that support family and community events

27.6% Activate adjacent under-utilized parts of the park

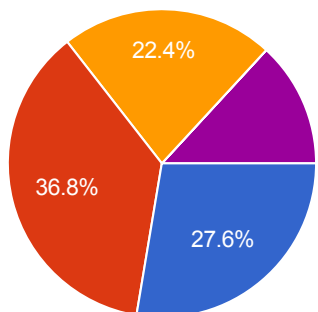

What is the greatest challenge?

36.8% Connectivity and parking (not enough)

27.6% Designing for multiple user groups and ages

What age groups should the garden's design focus on?

56.6% 5-12

46.1% 2-5

38.2% All age groups

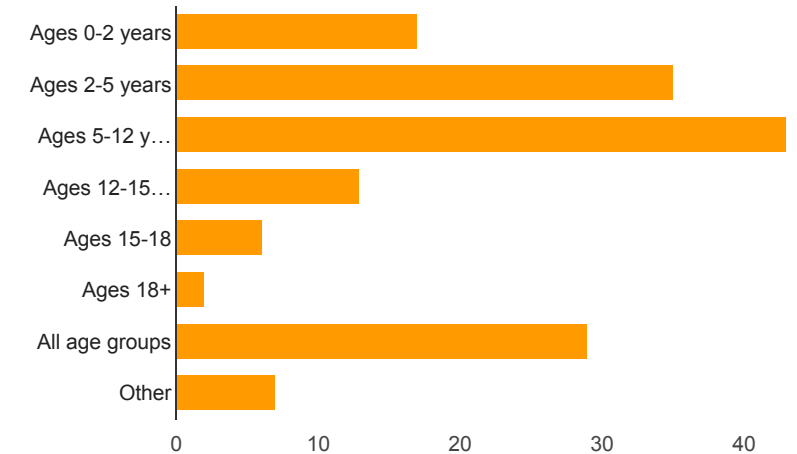

What focus would you like to see in the design?

48.7% Creative Play

44.7% Sensory Development

43.4% Nature Contact

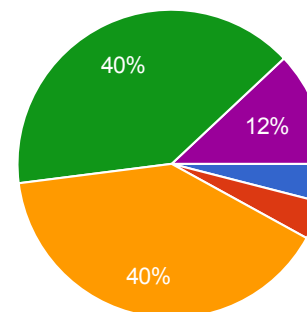
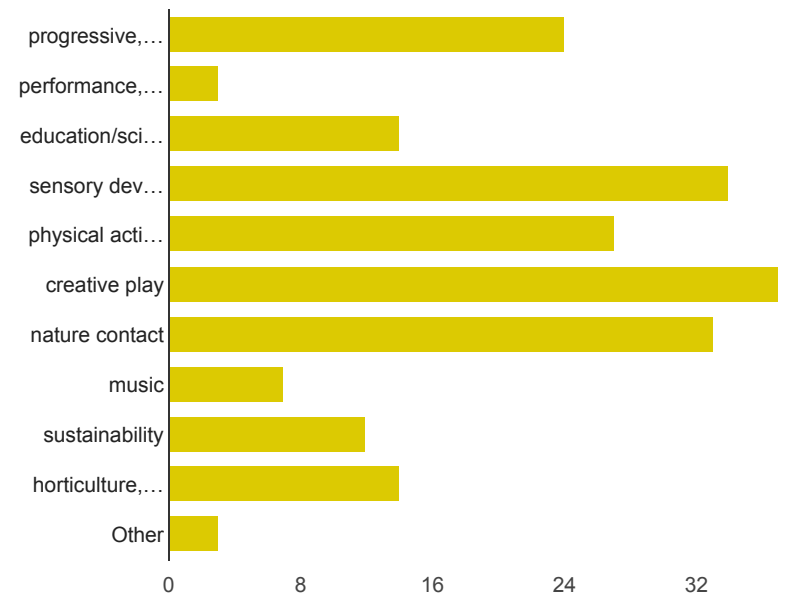

What level of food service would you like to see?

40% No Food Service

40% Food Trailer

WHAT WE HEARD



SHADE IS ESSENTIAL



EXPERIENTIAL PLAY IS A MUST



MUST HAVE SWINGS



BERM SLIDES WOULD BE WELL LOVED



MATERIALS MUST REFLECT AUSTIN'S NATURAL ENVIRONMENT

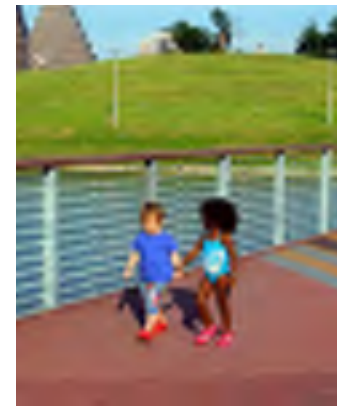

THIS SHOULD BE A CULTURAL PARK



BALANCE NATURAL AND SYNTHETIC MATERIALS



CREATE A VISUALLY STRIKING PARK

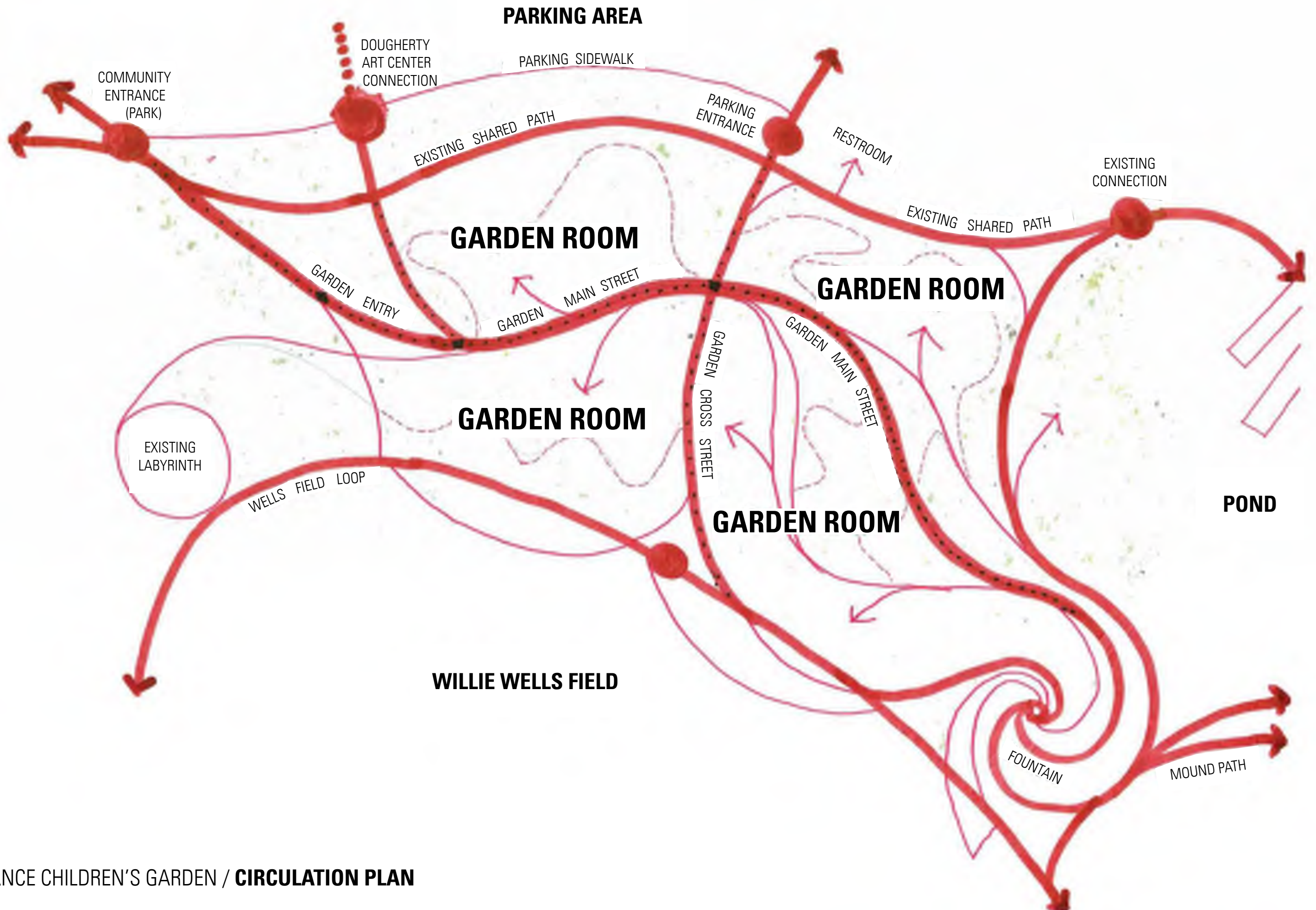

ALLIANCE CHILDREN'S GARDEN / **CIRCULATION PLAN**

