

In November of 1998, Austin voters approved a motor vehicle rental tax to fund development of the Palmer Events Center venue, parking facilities, and related parkland. In 1999, the Austin City Council approved a master plan for the area which contemplates spending up to \$ 18.5 million for the related parkland improvements.

This place is to be a **children's garden** that will represent the unique **culture of Austin** through **contextual forms, imaginative play, playful elements, and strong aesthetics.**

The goal will be the creation of a **multigenerational** play venue that is **comfortable, inviting, imaginative, engaging and visually striking.**

OUR OBJECTIVES

- **IMAGINATION DRIVEN**
enable children to engage through active exploration and creative play to support physical, mental and sensory development capabilities
- **EXTENSION OF PLAY**
provide a comfortable experience for both children and adults to extend the time spent in play
- **INCLUSIVE FOR ALL**
although child-centric in focus, the garden will engage all ages, skill levels and physical capabilities

PUBLIC ENGAGEMENT

- DECEMBER 5, 2015 - COMMUNITY ENGAGEMENT MEETING #1
- JANUARY 7, 2016 - CONCEPTUAL DESIGN MEETING
- MARCH 9, 2016 - COMMUNITY OPEN HOUSE
- BOARDS AND COMMISSIONS MEETINGS, DATES TO BE DETERMINED
- OTHER ENGAGEMENT OPPORTUNITIES - ONLINE SURVEY, WEBSITE, EMAIL, PHONE

WEBSITE: <http://austintexas.gov/alliancechildrensgarden> **EMAIL:** Robin.Camp@austintexas.gov

PUBLIC INPUT

- SHADE IS ESSENTIAL
- EXPERIENTIAL PLAY IS A MUST
- MUST HAVE SWINGS
- BERM SLIDES WOULD BE WELL LOVED
- MATERIALS MUST REFLECT AUSTIN'S NATURAL ENVIRONMENT
- THIS SHOULD BE A CULTURAL PARK
- BALANCE NATURAL AND SYNTHETIC MATERIALS
- CREATE A VISUALLY STRIKING PARK



T B G ALLIANCE CHILDREN'S GARDEN / SITE PLAN



📍 Austin, TX
👤 PARD
📅 09 March 2016



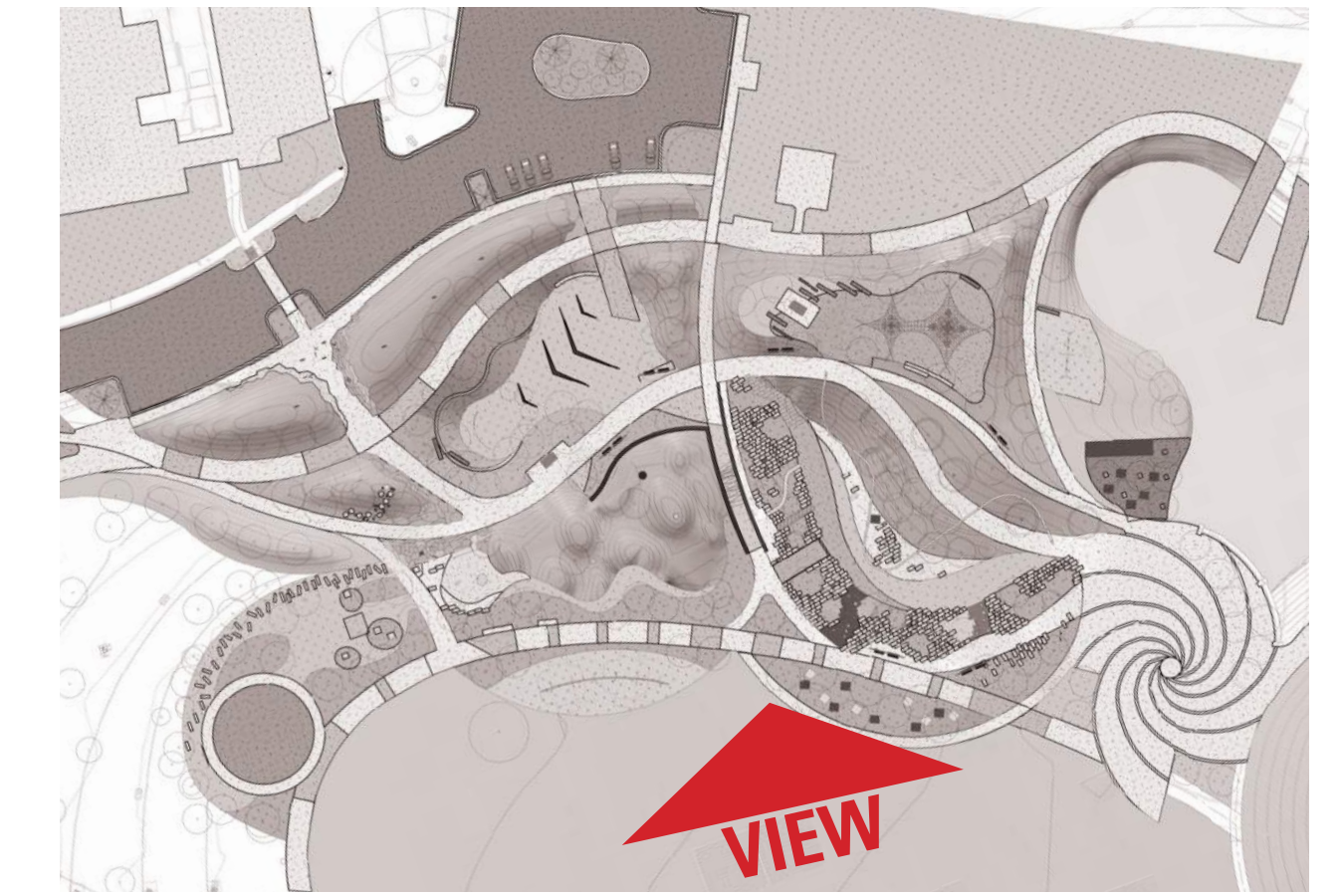

This place is to be a **children's garden** that will represent the unique **culture of Austin** through **contextual forms, imaginative play, playful elements, and strong aesthetics**. The goal will be the creation of a **multigenerational** play venue that is **comfortable, inviting, imaginative, engaging and visually striking**.

LEGEND

- 01. WILLIE WELLS FIELD
- 02. ENHANCED SHADED PICNIC AREA
- 03. FIELD SWINGS
- 04. WILLIE WELLS FIELD LOOP PATH
- 05. ROCK AND SLIDE GARDEN
- 06. FUTURE FOUNTAIN SEATING AREA
- 07. LIZ CARPENTER FOUNTAIN
- 08. SHADE CANOPIES
- 09. BERM SLIDES
- 10. EXPLORATION GROVE
- 11. EXPLORATION TRAILS
- 12. FUTURE FOUNTAIN IMPROVEMENT
- 13. EXISTING WET POND
- 14. CLIMBING NETS
- 15. GAMES SPACE
- 16. CLIMBING WALLS
- 17. ART AND CULTURE GARDEN
- 18. HILL COUNTRY PLAYSCAPE
- 19. MUSICAL ELEMENTS
- 20. SAND PLAY
- 21. POETRY GARDEN
- 22. ALLIANCE CHILDREN'S GARDEN GATEWAY
- 23. DOUGHERTY ARTS CENTER
- 24. PORCH SWINGS
- 25. SWINGS AT THE POND
- 26. EXISTING PUBLIC RESTROOM
- 27. SHARED USE BICYCLE TRAIL

T B G ALLIANCE CHILDREN'S GARDEN / **GARDEN AERIAL PERSPECTIVE VIEW**



ALLIANCE CHILDREN'S GARDEN / **ROCK AND SLIDE VALLEY**

📍 Austin, TX

👤 PARD

📅 09 March 2016



ALLIANCE CHILDREN'S GARDEN / HILL COUNTRY PLAYScape, ROCK AND SLIDE VALLEY

📍 Austin, TX

👤 PARD

📅 09 March 2016



ALLIANCE CHILDREN'S GARDEN / SKYLINE VIEW GARDEN

📍 Austin, TX 👤 PARD 📅 09 March 2016